



**Afton**  
*Full-Wrap*  
*Contemporary Ogee*

The Afton edge profile blends the refined look of the double-waterfall ogee with the sophistication of a full-wrap edge. The result, a subtle yet compelling profile befitting the transitional design's aesthetic.

## Afton Full-Wrap Contemporary Ogee

### Expect More from VT Dimensions

Bring together modern style, intriguing depth, and the seamless edge you want with the beautifully contoured look of VT Dimensions countertops.

Beyond the beauty, you'll have the assurance of knowing VT fabricates the whole countertop from top to bottom—not just the laminate surface—for consistent quality and service. And you get a 1-year warranty you can count on.

One source. Many beautiful looks. Only from VT.



Edge: Afton  
Laminate: Elemental Concrete  
Formica® 8830-58

### Specifications

- Standard substrate is 3/4" industrial-grade particleboard, available in 8', 10', and 12' lengths
- Standard postformed-grade laminate with a thickness of 0.042" + 0.002" - 0.008"
- Both standard and special styles and sizes are suitable for all residential, commercial, institutional, or light-industrial applications
- Available surfaced with Formica®, Nevamar®, Pionite®, and Wilsonart® laminate
- Available as an environmentally friendly EQcountertop
- Not available surfaced with solid color laminates

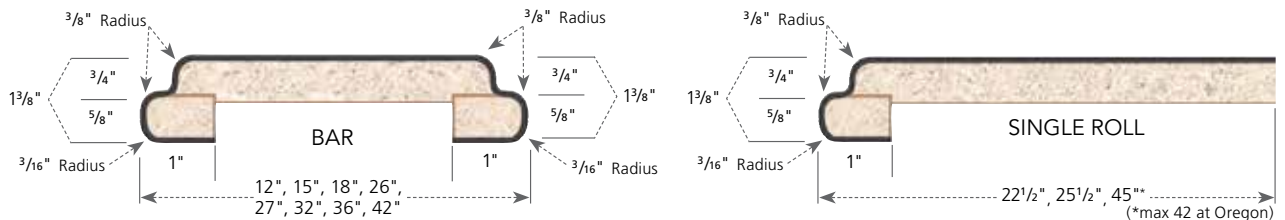
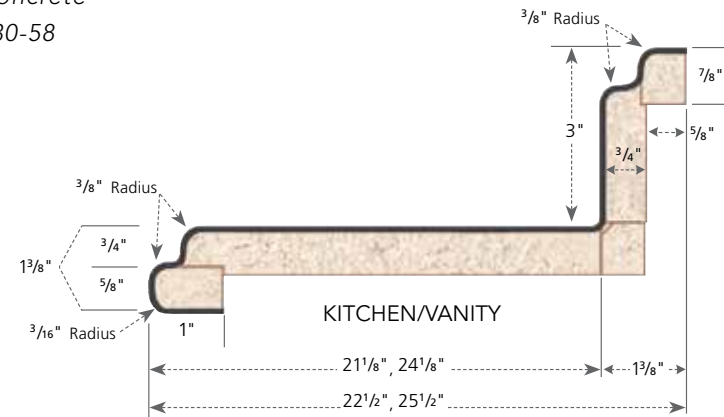

VTDimensions.com | 1-888-287-8356  
1000 Industrial Park | P.O. Box 490 | Holstein, IA 51025

©2015 VT Industries, Inc. All rights reserved.  
NPAF 0615



All measurements in inches. Drawings not to scale.